

Veneers

The widest selection of popular and exotic veneers:



Veneer Sample Books are available upon request. Don't see what you need? Call us at (800) DOORS-4-U, and we'll get it for you.

Flush Doors

All types — Hollow Core (HC), Solid Particle Core (PC), Structural Composite Lumber (SCL)

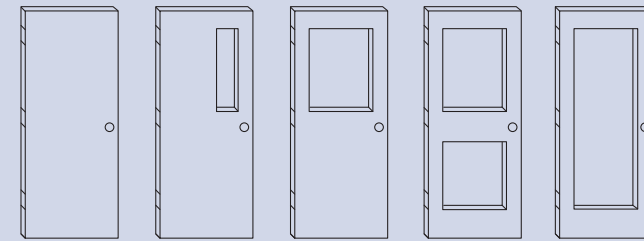

... and more options are available.

Hollow Metal Doors and Frames

Manhattan Door carries one of the largest selections of standard hollow metal doors and frames. All are ready to go on demand. Looking for something different? We're always there to fulfill your custom orders. Just give us the specs!

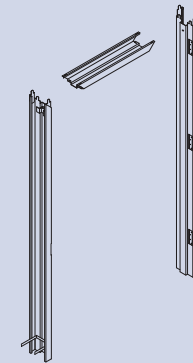

Fire Doors

Our entire catalog of quality doors is available with 20, 45 or 90-minute fire ratings.



Acoustical Doors

We also offer acoustical doors with STC (Sound Transmission Class) ratings that measure resistance to the passage of audible sounds.

Architectural Hardware

Manhattan Door offers a wide range of finish hardware from all major hardware lines. We have what you want. And we can get what you need, no matter how demanding your project's specifications.

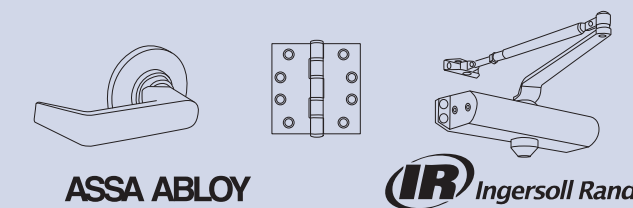

DOOR-N-24 FAST TRACK PROGRAM
NEED A DOOR NOW? Almost any size slab flush wood door can be ready in 24 hours! Ask for details.



We'll make your door right, the FIRST TIME.

We're experts at having any door custom-crafted, no matter what the job. Come visit us in our new 100,000 square foot, state-of-the-art manufacturing facility and distribution center located in Carlstadt, New Jersey, just minutes outside the Lincoln Tunnel.

Manhattan Door doors are:

- Component manufactured locally.
- Custom-sized and made to order.
- Constructed from the finest materials.
- Built to your exact specifications.
- Fire rated with any veneer.
- Available with special features including:
 - Customized machining to any specification using 21st century CNC equipment
 - Architectural veneers
 - Solid hardwood edges
 - FSC-certified



We carry the largest inventory of ready-to-go paint grade and stain grade doors. And, we never size a door by "ripping" or cutting down a stock item. Every custom-sized door is built to spec. So for the right door, in any size, make Manhattan Door your first stop.

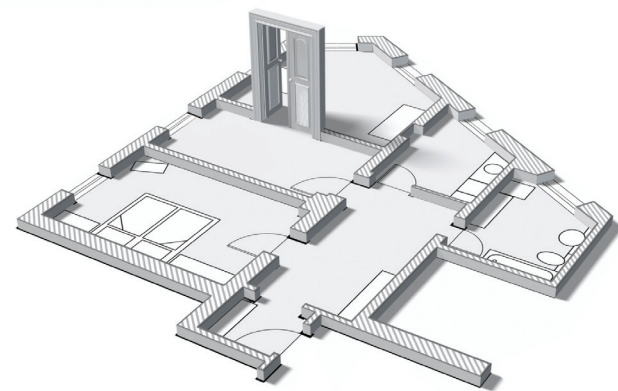

Fast turnaround and jobsite delivery, ON TIME.

When doors are late, everybody loses. That's why we deliver our customized, finished doors within days, instead of the industry average of a month or more.

We are door experts and do the hard work for you.

- We come to your jobsite.
- We ask the right questions.
- We help you decide on the ideal door solution.
- We guide you through the best, most cost-effective options.
- We personally expedite your order so it stays on schedule.

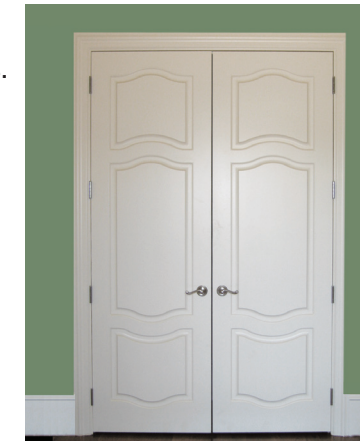

And fast turnaround means just that.

- Our **Door-N-24 Program** can get your doors ready within a day.
- Larger orders can be completed in only 7 days or less.
- No job is too large or too small.
- Orders are efficiently scheduled for production in the shortest possible timeframe.
- Dedicated delivery means dependable, safe, and on-time arrival of our products to your project.

Most importantly, because our doors are shipped factory-direct, our customers get products faster. We deliver finished orders daily — anywhere in the NY Metro Area... and Pennsylvania.

We've got the right doors for you, EVERY TIME.

Manhattan Door is easily accessible from any of the NYC boroughs, Long Island, Westchester, Connecticut and New Jersey. And our close relationships with all of our vendors mean we can quickly advise you on the product options that best meet your needs. We treat a single-door order with the same attention to detail and meticulous care as we do our larger projects. For us, every door counts!

Manhattan Door is a key area distributor of:

- Flush wood doors – either slabs, fully machined, or "pre-hung" units.
- Molded panel, stile-and-rail, and carved face doors.
- The widest selection of doors with exotic veneers.
- Hollow metal doors with steel knocked-down or welded frames.
- Top-quality finish hardware, including hinges, locks, knobs and levers.

Make Manhattan Door a part of your planning process from the very beginning, whether it's 4 doors or 40 floors. We'll always add value to your entire project, while avoiding costly mistakes and delays. Manhattan Door is experienced at filling even the most demanding order.

More questions? Visit www.manhattandoor.com for more answers, including our ordering and contact information.

Manhattan Door takes the "LEED" toward GREEN.

Today, sustainable development is not only an important environmental consideration, but it is also one of the most effective ways to reduce building operating costs. The U.S. **GREEN** Building Council (USGBC) is a 501(c)(3) nonprofit community of leaders working to make **GREEN** buildings available to everyone within a generation. Its LEED certification system provides building owners and operators with a concise framework for identifying and implementing practical and measurable **GREEN** building design, construction, operations and maintenance solutions.

A breadth of knowledge and a keen understanding of LEED criteria have become entry requirements to many current construction projects in the tri-state area. Manhattan Door's FSC-certified products have been "LEED-ing" the way in environmentally sustainable developments in our industry for years.



Manhattan Door can maximize your LEED points because its GREEN products are:

- FSC-certified for wood content under Pure, Mixed, and Controlled Wood product classifications.
- Manufactured within a 500-mile radius.
- Offered with natural agri-fiber cores.
- Formaldehyde-free.
- Produced without added urea formaldehyde.
- Finished using Zero/Low VOC paints and coatings.
- Made with pre-consumer recycled content.

Here at Manhattan Door, we are experts in meeting USGBC LEED accreditation requirements. Give us your blueprint and project specs, and we'll make sure that all wall panels and doors are correctly manufactured and properly sequenced because we offer the highest standards of professional excellence.

If we can
make it
here...

How does Manhattan Door serve you...better?

Q: Waiting 4 - 6 weeks for your doors?

A: No! Manhattan Door offers fast turnaround on all doors we make in our new 100,000 square foot manufacturing and distribution facility, less than 10 miles from midtown Manhattan.

Q: Ever been left *holding the bag* because of inadequate specifications?

A: Not with your Manhattan Door order. Our expert sales staff will guide you through the entire production process, highlighting potential inconsistencies before they become costly mistakes.

Q: Do you have LEED compliance concerns?

A: No worries - Manhattan Door has the answers to your **GREEN** questions. For years, our FSC-certified products have been "LEED-ing" the way in environmentally sustainable developments in our industry.

Q: Too hard to manage the many suppliers needed to complete each opening?

A: Manhattan Door offers one-stop shopping for wood, MDF and hollow metal doors, plus top-quality architectural hardware. We also pre-finish doors with either a clear UV coating or a custom stain to match your existing woodwork to complete a total door solution.

Q: Do you worry about the quality of the doors you buy?

A: Not when you buy from Manhattan Door. For three generations, we have stood behind every door we made thanks to our commitments to quality, innovation, and customer service.

See for yourself. Call (800) DOORS-4-U TODAY!

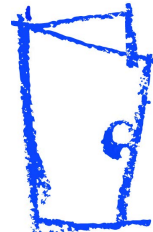

I  NY,
NJ, PA, CT, and...

we can
make it
anywhere!

Manhattan Door Products

Manhattan Door provides most types and styles of wood and hollow metal doors for interior and exterior use. Our products are shipped factory-direct for the best possible savings.

We use only the highest quality materials and the most innovative manufacturing techniques, so we are able to supply doors that meet the most demanding safety, security and aesthetic requirements.

Panel Doors

Many of the most popular panel door designs are available on the fastest turnaround. Plus, we offer a complete selection of additional styles. Contact us for details!

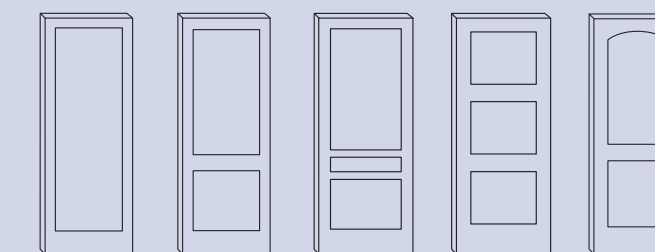

Panel Door Profiles

Achieve distinct looks by selecting from a wide variety of sticking and panel options. With so many combinations to choose from, you can't help but find the perfect profiles for your project.

Panel Profile Options

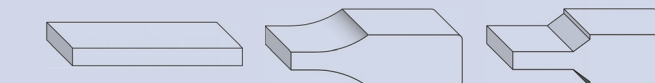

Flat Panel

Scoop Inset

Step Inset

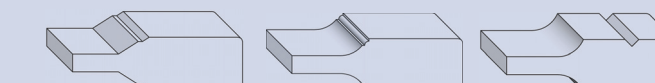

Double Hip Inset

Beaded Inset

V-Groove Inset

Sticking Profile Options

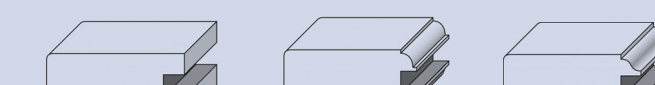

Square

Beaded

Ogee

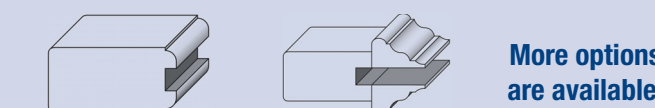

Quarter Round

Standard Panel Mold

More options
are available.
CONTACT US!